

| REV. | DESCRIPTION | DRAWN | CHECKED | APPROVED |
|------|-------------|---------------|---------|----------|
| A | NEW RELEASE | LJH 01/06/06' | | |
| | | | | |
| | | | | |

NOTES:

1. MATERIAL:
 - 1.1 Pin(outer sleeve): Brass, machined CuZn38Pb2.
 - 1.2 Clip(contact 4finger): Beryllium Copper or phosphor bronze.
 - 1.3 Insulator(black): Glass filled thermoplastic polyester UL94V-0.

2. ELECTRICAL:
 - 2.1 Current rating: 3Amps/contact max.
 - 2.2 Contact resistance: $\leq 20m\Omega$ /contact.
 - 2.3 Insulation resistance: $\geq 1000M\Omega$ at $V=100V$.
 - 2.4 Operating voltage: 60V AC/DC.

3. PRODUCT NUMBER CODE:

DS1002-05 - X X X

CLIP PLATING

- 6: Full Tin
- 8: Full gold flash
- C: Full gold 3u"
- A: Full gold 10u"

PIN PLATING

- 6: Full Tin
- 8: Full gold flash
- C: Full gold 3u"
- A: Full gold 10u"

No.OF CONTACTS

1*1 to 1*40

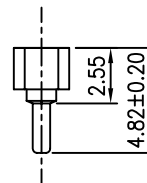
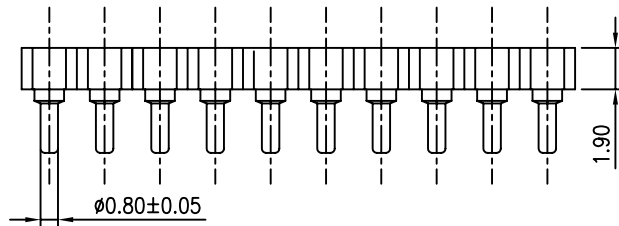
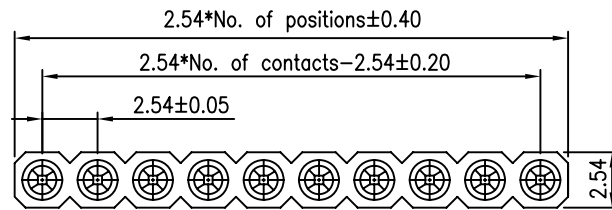

| GENERAL TOLERANCE | | ANGLE TOLERANCE | | PROJECTION | TITLE | IC SOCKET PITCH 2.54mm PIN LENGTH 4.82mm | |
|-------------------|-------|------------------|-----|--|-------|---|------------------|
| X. | ±0.60 | X. | ±5° | | | | |
| .X | ±0.38 | .X | ±3° | | mm | | |
| .XX | ±0.25 | .XX | ±2° | | A4 | SERIES | DS1002-05 SERIES |
| DRAWING TYPE | | CUSTOMER | | 晨翔电子有限公司 CONNFLY CONNFLY ELECTRONIC CO. LTD | | | |
| SCALE | | SHEET | | | | | |
| DRAWING NO. | | C-DS1002-05-XXXX | | | | | |