

REV.	DESCRIPTION	DRAWN	CHECKED	APPROVED
A	NEW RELEASE	LL 07/03/06'		

NOTES:

- ELECTRICAL:
 - Current rating: 3Amps/contact max.
 - Contact resistance: $\leq 20\text{m}\Omega/\text{contact}$.
 - Insulation resistance: $\geq 1000\text{M}\Omega$ at $V=100\text{V}$.
 - Operating voltage: 60V AC/DC.

2. PRODUCT NUMBER CODE:

DS1002-09 - X X X X

- CLIP PLATING
 - Tin 150u"
 - Tin 200u"
 - G/F
 - Gold 3u"
 - Gold 10u"
 - Gold 15u"
- PIN PLATING
 - Tin 150u"
 - Tin 200u"
 - G/F
 - Gold 3u"
 - Gold 10u"
 - Gold 15u"
- MOUNTING TYPE
 - R: R/A TYPE
 - S: SMT TYPE
- No. OF CONTACTS
 - 1*1 to 1*40
 - 2*2 to 2*40
- SERIES NO
DS1002-09

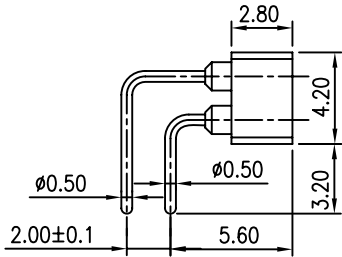

DUAL ROWS

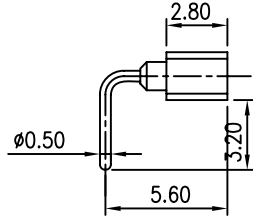

SINGLE ROW

R/A TYPE

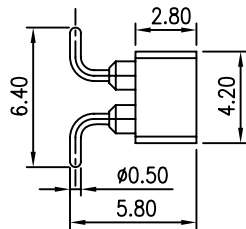
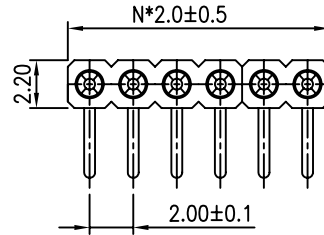

DUAL ROWS

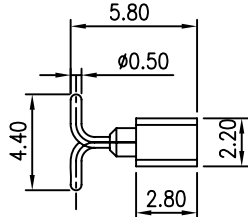

SINGLE ROW

SMT TYPE

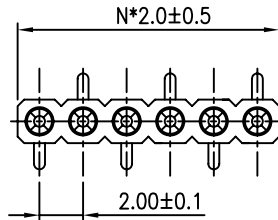

GENERAL TOLERANCE

X. ± 0.60
 .X ± 0.38
 .XX ± 0.25

ANGLE TOLERANCE

X. $\pm 5^\circ$
 .X $\pm 3^\circ$
 .XX $\pm 2^\circ$

PROJECTION



TITLE

IC SOCKET R/A&SMT TYPE PITCH 2.00mm

UNITS

mm

SHEET SIZE

A4

SERIES

DS1002-09 SERIES

DRAWING TYPE

CUSTOMER

SCALE

1:1

SHEET

10F1

DRAWING NO.

C-DS1002-09-XXXX



晨翔电子有限公司
CONNFLY CONNFLY ELECTRONIC CO. LTD