

# 9001 Series

## DIN41612 M Type Female

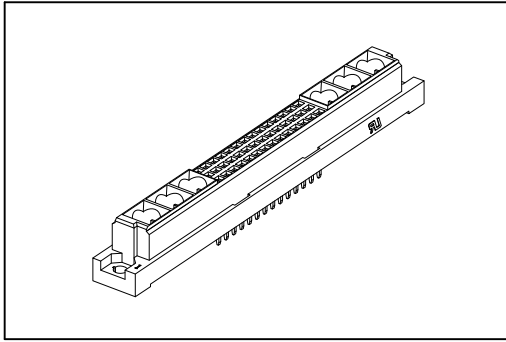

### Material:

Housing: Thermoplastic Polyester Glass Filled UL94V-0.  
 Contacts: Copper Alloy.

### Electrical Characteristics:

Current Rating: 2 A.  
 Dielectric Withstanding Voltage: AC 1000V.  
 Insulator Resistance: 1000MΩ min.  
 Contact Resistance: 20mΩ max.  
 Operating Temperature: -55°C ~+125°C.

### Features:

\* Mates with Male 9001-91  
 9001-93

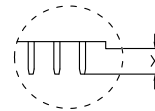
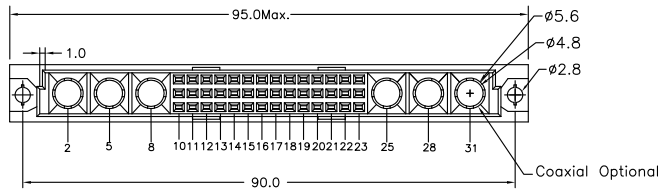

Dip Type

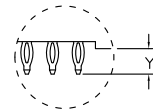

Press Fit Type

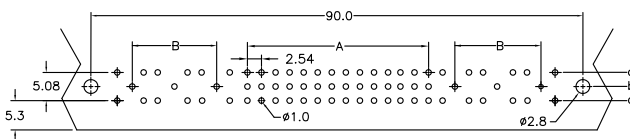
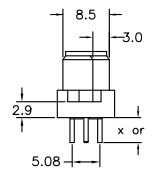
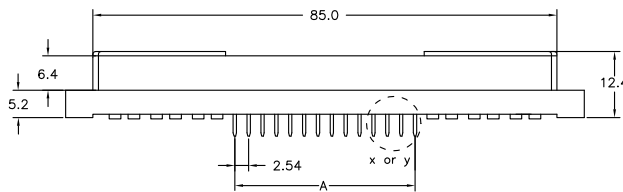

P.C. Board Layout (Coaxial)

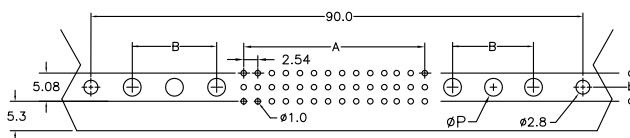

P.C. Board Layout (Power)

Current Rating(A)	10A	20A	30A	40A
Dimension(øP)	2.10	3.25	3.57	4.15
Length	1	2	W1	W2
X	4.0	2.5	13	17
Y	4.6	6.3	13	17
Dimension				
A	(2.54 x No of Contact)/3-2.54			
B	(7.62 x No of Coaxial)/2-7.62			
Pitch	Position	Rows with Contacts	Contact Arrange	with Coaxial Or Power
2.54mm	78	a b c		2 Pcs
	60	a b c		4 Pcs
	42	a b c		6 Pcs
	24	a b c		8 Pcs
	6	a b c		10 Pcs
	52	a - c		2 Pcs
	40	a - c		4 Pcs
	28	a - c		6 Pcs
	16	a - c		8 Pcs
	4	a - c		10 Pcs

## Ordering information

9001- 9 2 42 06 1 C 00 D A  
 Series 2: Female Position 02: With 2 Coaxial or Power 1: Dip Length C: Selective Gold 00: G/F D: Dip Type A: Tray  
 04: With 4 Coaxial or Power 2: Dip Length Plated P: Press Fit Package  
 06: With 6 Coaxial or Power W1: Dip Length Type  
 08: With 8 Coaxial or Power W2: Dip Length  
 10: With 10 Coaxial or Power

\* The Special Contacts Must be Ordered Separately, Pls Refer to Page CC03.