

# HSS 621 M

High Current Probe up to 75 A  
Plug-in Test Probe

NEW

Grid:

≥ 6,35 mm

≥ 250 Mil

Installation height with KS: 10,8 mm (.425)

Recommended stroke: 4,4 mm (.173)

## Mounting and functional dimensions

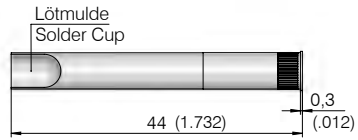
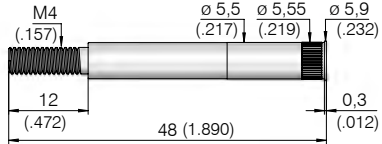
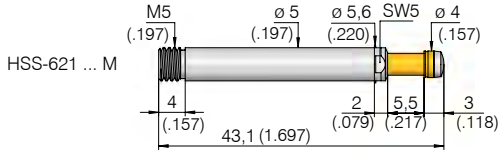

KS-621 M4 M5-R

KS-621 30 M5-R

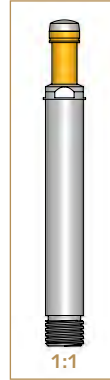

## Available tip styles

Material	Tip style	Plating	Further versions	
			∅	∅ (inch)
3 05*		S	∅ 4,00 (.157)	
3 06		A	∅ 5,00 (.197)	

\* pressed-in silver stud

### Materials

**Plunger:** BeCu, gold-plated or silver stud  
**Barrel:** Brass, silver-plated  
**Spring:** Stainless steel  
**Receptacle:** Brass, gold-plated

### Operating temperature

**Standard:** -100° up to +200° C

### Mounting hole size

for KS-621 xx M5-R  
in CEM1 and FR4: ∅ 5,50 - 5,52 mm (.2165 - .2173)

### Recommended tightening torque

HSS-621 M in KS-621: 40 cNm  
Cable at KS-621: 2 Nm  
Solder connection KS-621  
for cable with wire cross section: ≤ 10 mm<sup>2</sup>

### Electrical data

**Current rating (at room temp.):** max. 75 A  
**R<sub>j</sub> typical:** < 5 mΩ

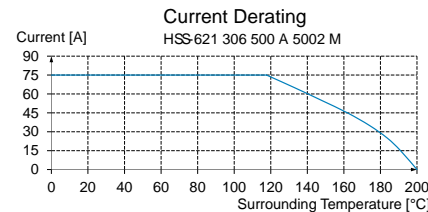
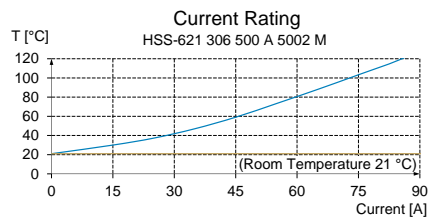

### Mechanical data

**Working stroke:** 4,4 mm (.173)  
**Maximum stroke:** 5,5 mm (.217)  
**Spring force at work. stroke:** 5,0 N (18.1oz)  
**Alternative:** 10,0 N (36oz)

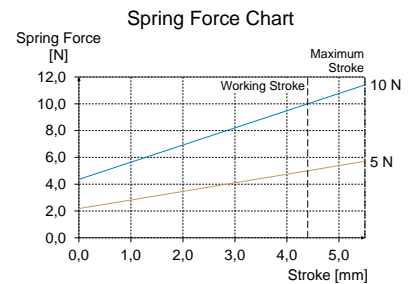

## Ordering example

Series	Tip material	Tip style	Tip diameter (1/100 mm)	Plating	Spring force (dN)	Collar height (mm)	Type
	3 = BeCu			A = Gold S = Silver			
Test probe:	HSS	621	306	500	A	50	02 M
Receptacles:	KS-621	M4 M5-R	KS-621	30 M5-R			