

NEW

HSS 623 M

High Current Probe up to 100 A
Screw-in Test Probe

Grid:
≥ 7,60 mm
≥ 300 Mil

Installation height with KS: 10,8 mm (.425)
Recommended stroke: 4,4 mm (.173)

Mounting and functional dimensions

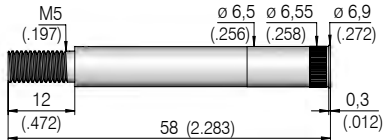
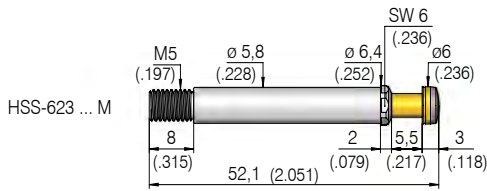

KS-623 M5 M5-R

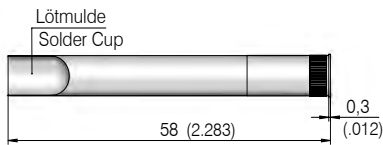

KS-623 30 M5-R



Available tip styles

Material	Tip style	Plating	Further versions	
			∅	∅ (inch)
3	05*	S	∅ 6,00 (.236)	
3	06	A	∅ 6,00 (.236)	

* pressed-in silver stud

Materials
Plunger: BeCu, gold-plated or silver stud
Barrel: Brass, silver-plated
Spring: Stainless steel
Receptacle: Brass, gold-plated

Operating temperature
Standard: -100° up to +200° C

Mounting hole size
for KS-623 xx M5-R
in CEM1 and FR4: ∅ 6,50 - 6,52 mm (.2559 - .2567)

Recommended tightening torque
HSS-623 M in KS-623: 40 cNm
Cable at KS-623: 4 Nm
Solder connection KS-623
for cable with wire cross section: ≤ 16 mm²

Electrical data
Current rating (at room temp.): max. 100 A
R_i typical: < 5 mΩ

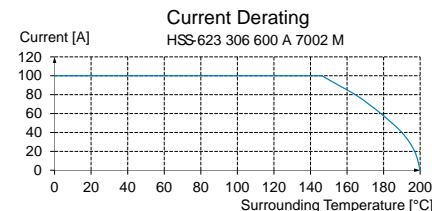
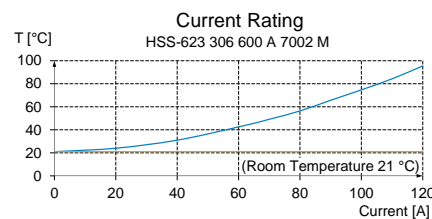

Mechanical data
Working stroke: 4,4 mm (.173)
Maximum stroke: 5,5 mm (.217)
Spring force at work. stroke: 7,0 N (25.2oz)
Alternative: 10,0 N (36oz); 15,0 N (54oz)

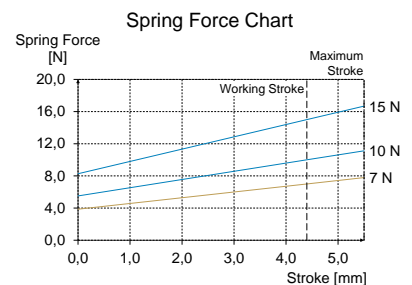

Ordering example

Series Tip material Tip style Tip diameter (1/100 mm) Plating (A = Gold, S = Silver) Spring force (dN) Collar height (mm) Type

Test probe:

H S S 6 2 3 3 0 6 6 0 0 A 7 0 0 2 M

Receptacles:

K S - 6 2 3 M 5 M 5 - R K S - 6 2 3 3 0 M 5 - R