

## Features

- ◆ Viewing angle:120 deg
- ◆ The materials of the LED dice is InGaN
- ◆ 3.80mm×1.00mm×0.60mm
- ◆ RoHS compliant lead-free soldering compatible

## Applications

- ◆ LCD Back Light.
- ◆ Mobile phones .
- ◆ Indicators.
- ◆ Illuminations.
- ◆ Switch Lights.

## Package Outline Dimensions

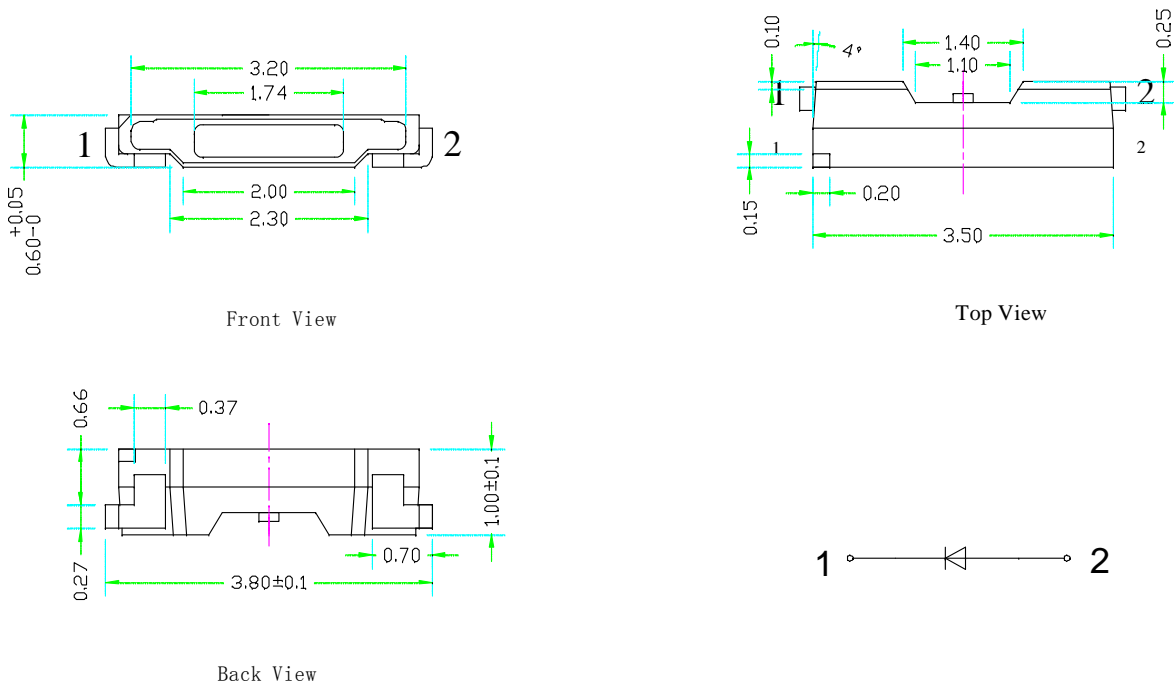

## NOTES:

1. All dimensions are in millimeters
2. Tolerances are  $\pm 0.1$ mm unless otherwise noted.

### Absolute maximum ratings at Ta=25°C

Parameter	Symbol	Value	Unit
Forward current	If	30	mA
Reverse voltage	Vr	5	V
Operating temperature range	Top	-20~+85	°C
Storage temperature range	Tstg	-35 ~+85	°C
Peak pulsing current	Ifp	100	mA
Electrostatic Discharge	ESD	2000(HBM)	V

### Electro-optical characteristics at Ta=25°C

Parameter	Test Condition	Symbol	Value			Unit	
			Min.	Typ.	Max.		
Forward voltage	If=20mA	Vf	V9	2.9	--	3.0	V
			V0	3.0	--	3.1	
			V1	3.1	--	3.2	
			V2	3.2	--	3.3	
			V3	3.3	--	3.4	
			V4	3.4	--	3.5	
Luminous intensity	If=20mA	Iv	20	2000	--	2070	mcd
			21	2070	--	2140	
			22	2140	--	2210	
			23	2210	--	2280	
			24	2280	--	2350	
			25	2350	--	2420	
			26	2420	--	2490	
			27	2490	--	2560	
			28	2560	--	2630	
			29	2630	--	2700	
Viewing angle at 50% Iv	If=20mA	2 θ 1/2	--	120	--	Deg	
Reverse current	Vr=5V	Ir	--	--	10	μ A	

**NOTE:** (Tolerance: Iv ±10%, Vf ±0.05V, X,Y ±0.01)  
IFP Conditions: Pulse Width ≤ 10msec. and Duty ≤ 1/10.

## Chromaticity Bin

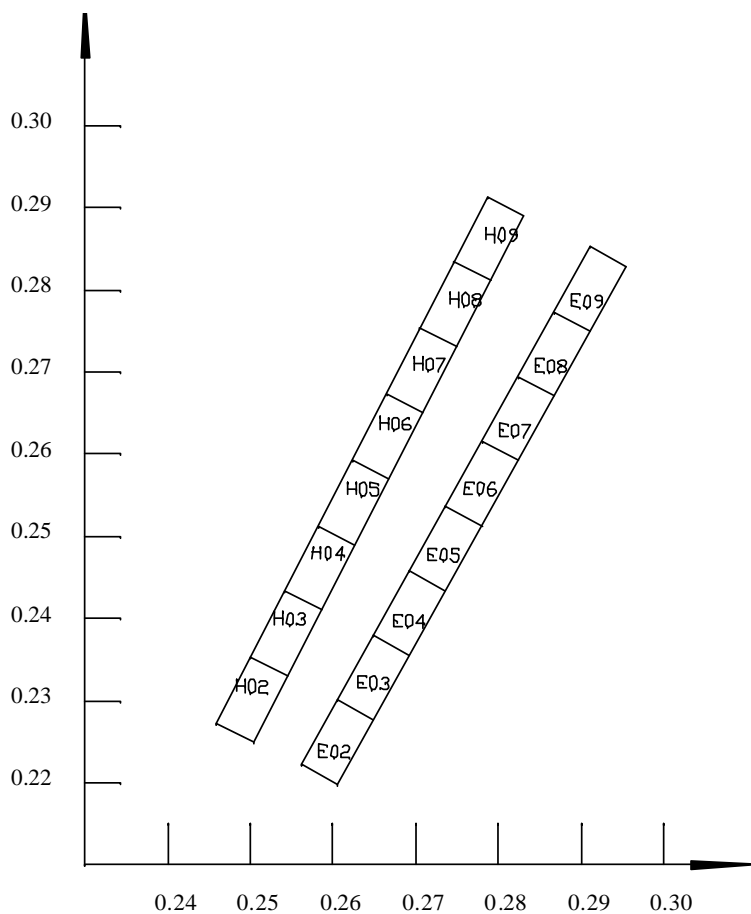

### Bin data:

BIN CODE	CIE-X1	CIE-Y1	CIE-X2	CIE-Y2	CIE-X3	CIE-Y3	CIE-X4	CIE-Y4
E02	0.2605	0.2198	0.2562	0.2222	0.2605	0.2301	0.2649	0.2277
E03	0.2649	0.2277	0.2605	0.2301	0.2649	0.2380	0.2693	0.2355
E04	0.2693	0.2355	0.2649	0.2380	0.2693	0.2458	0.2737	0.2434
E05	0.2737	0.2434	0.2693	0.2458	0.2736	0.2537	0.2780	0.2513
E06	0.2780	0.2513	0.2736	0.2537	0.2780	0.2616	0.2824	0.2592
E07	0.2824	0.2592	0.2780	0.2616	0.2824	0.2694	0.2868	0.2670
E08	0.2868	0.2670	0.2824	0.2694	0.2868	0.2773	0.2911	0.2749
E09	0.2911	0.2749	0.2868	0.2773	0.2911	0.2852	0.2955	0.2828
H02	0.2504	0.2250	0.2460	0.2272	0.2501	0.2352	0.2545	0.2330
H03	0.2545	0.2330	0.2501	0.2352	0.2542	0.2433	0.2586	0.2410
H04	0.2586	0.2410	0.2542	0.2433	0.2582	0.2513	0.2627	0.2490
H05	0.2627	0.2490	0.2582	0.2513	0.2623	0.2593	0.2668	0.2570
H06	0.2668	0.2570	0.2623	0.2593	0.2664	0.2673	0.2709	0.2650
H07	0.2709	0.2650	0.2664	0.2673	0.2705	0.2753	0.2750	0.2731
H08	0.2750	0.2731	0.2705	0.2753	0.2746	0.2833	0.2791	0.2811
H09	0.2791	0.2811	0.2746	0.2833	0.2787	0.2914	0.2832	0.2891

## Typical optical characteristics curves

### Spectral Distribution

Relative Intensity vs. Wavelength (Ta=25°C)

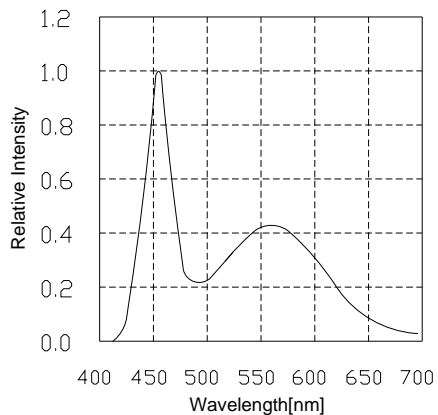

Forward Current vs. Forward Voltage (Ta=25°C)

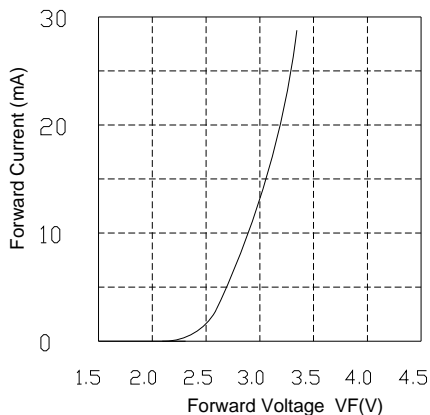

Relative Intensity vs. Forward Current (Ta=25°C)

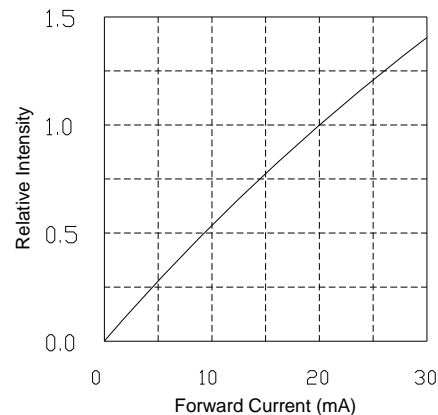

### Derating

Relative Intensity vs. Ambient Temperature

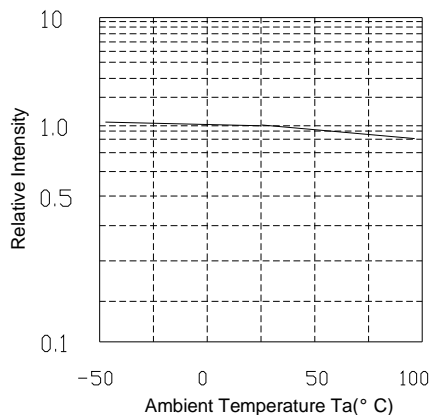

Maximum Forward Current vs. Ambient Temperature

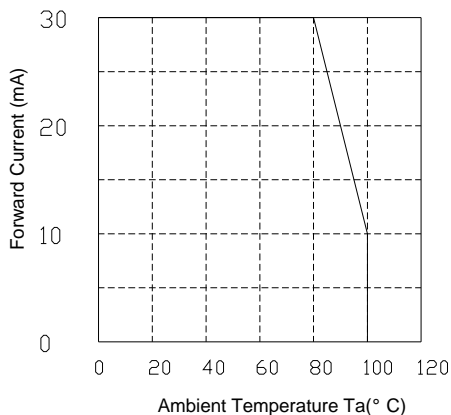

Forward Current vs. Chromaticity (Ta=25°C)

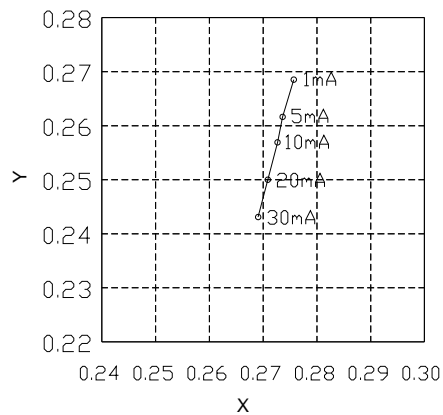

### Diagram characteristics of radiation

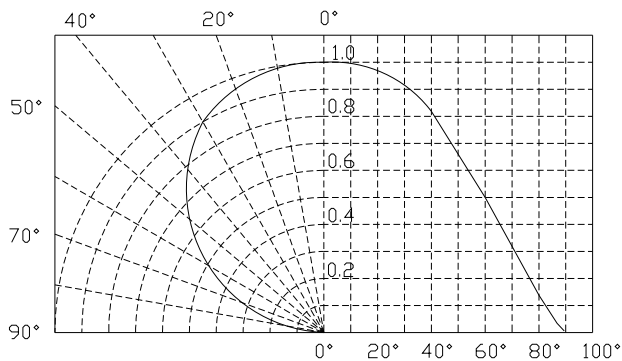

## Reflow profile

### ■ Soldering condition

- Recommended soldering conditions

Reflow Soldering		Hand Soldering	
Pre-heat	160~180°C	Temperature	300°C Max.
Pre-heat time	120 seconds Max.	Soldering time	3 second Max. (one time only)
Peak temperature	260°C Max.		
Soldering time	10 seconds Max.		
Condition	Refer to Temperature-profile		

- After reflow soldering rapid cooling should be avoided

### ■ Temperature-profile (Surface of circuit board)

Use the following conditions shown in the figure.

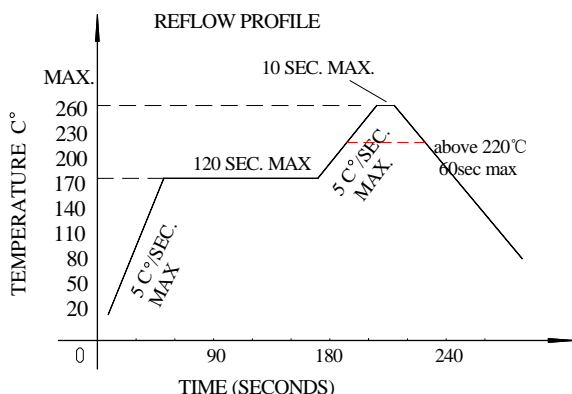

### RECOMMEND PAD DESIGN (Units: mm)

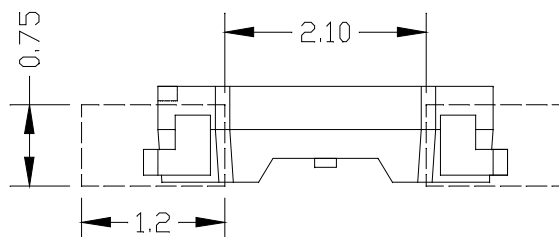

1. Reflow soldering should not be done more than two times
2. When soldering ,do not put stress on the LEDs during heating

### ■ Soldering iron

1. When hand soldering, keep the temperature of the iron under 300°C, and at that temperature keep the time under 3 sec.
2. The hand soldering should be done only a time
3. The basic spec is  $\leq 5$  sec. when the temperature of 260°C, do not contact the resin when hand soldering

### ■ Rework

1. Customer must finish rework within 5 sec under 260°C
2. The head of iron can not touch the resin
3. Twin-head type is preferred.

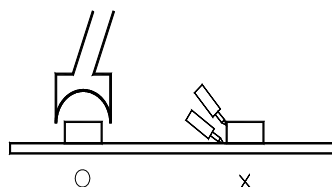

## ■ CAUTIONS

The encapsulated material of the LEDs is silicone . Therefore the LEDs have a soft surface on the top of package. The pressure to the top surface will be influence to the reliability of the LEDs. Precautions should be taken to avoid the strong pressure on the encapsulated part. So when using the picking up nozzle, the pressure on the silicone resin should be proper.



## Reliability

### (1) TEST ITEMS AND RESULTS

Type	Test Item	Ref. Standard	Test Conditions	Note	Number of Damaged
Environmental Sequence	Resistance to Soldering Heat(Reflow Soldering)	JESD22-B106	Tsld=260°C,10sec	2 times	0/22
	Thermal Shock	JESD22-A106	-40°C 5min ↑↓10s 100°C 5min	300 cycle	0/22
	High Humidity Heat Storage	JEITA ED-4701 100 103	85°C,RH=85%	1000 hrs	0/22
Operation Sequence	Life Test	JESD22-A108	T <sub>a</sub> =25°C I <sub>F</sub> =20mA	1000 hrs	0/22
	Low Temperature Life Test	JESD22-A108	T <sub>a</sub> =-40°C	1000 hrs	0/22
	High Humidity Heat Life Test	JESD22-A101	60°C RH=90% I <sub>F</sub> =20mA	500 hrs	0/22

### (2) CRITERIA FOR JUDGING THE DAMAGE

Item	Symbol	Test Conditions	Criteria for Judgement	
			Min.	Max.
Forward Voltage	VF	IF=20mA	-	U.S.L*)×1.1
Reverse Current	IR	VR=5V	-	U.S.L*)×2.0
Luminous Intensity	IV	IF=20mA	L.S.L**)×0.7	-

U.S.L.: Upper Standard Level

L.S.L.: Lower Standard Level



REFOND

**Packaging Specifications**

● Feeding Direction

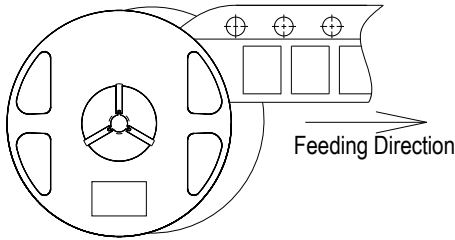

● Dimensions of Reel (Unit: mm)

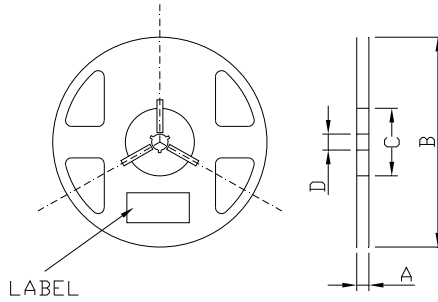

A	13.6±0.1mm
B	179±1mm
C	58±1mm
D	13.5±0.5mm

● Dimensions of Tape (Unit: mm)

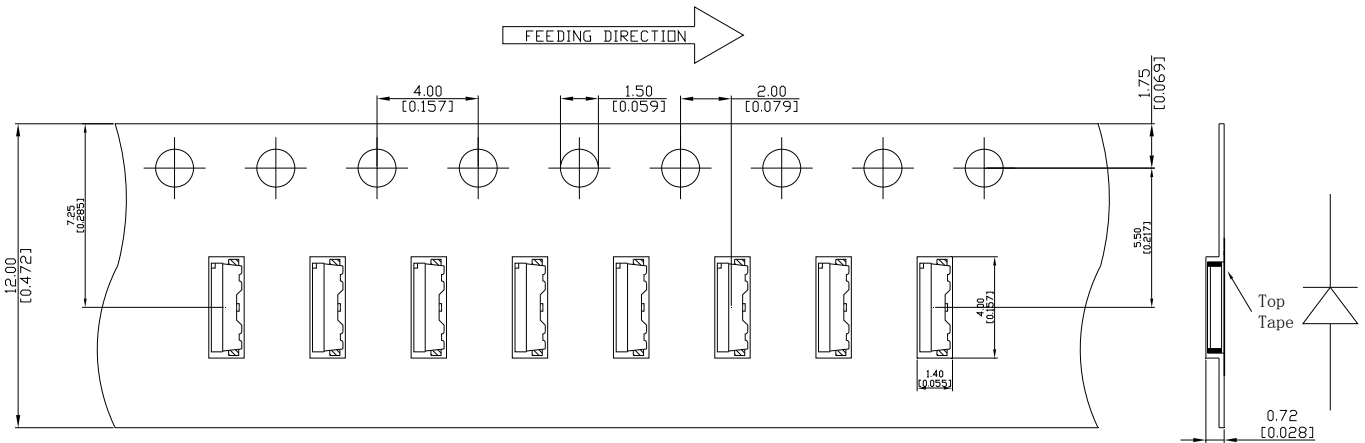

● Arrangement of Tape

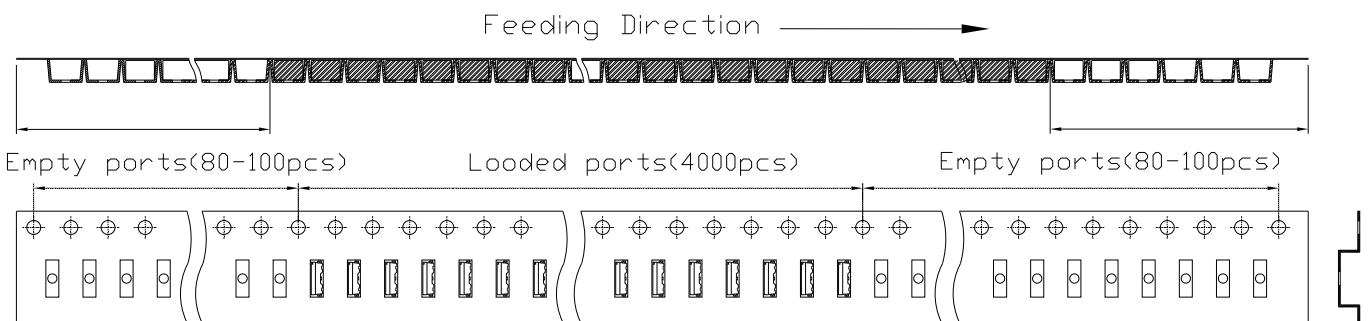

**NOTES**

1. Empty component pockets are sealed with top cover tape;
2. The maximum number of missing lamps is two;
3. The cathode is oriented towards the tape sprocket hole in accordance with ANSI/EIA RS-481 specifications.
4. 4,000 pcs/ Reel.



REFOND

### Packaging specifications

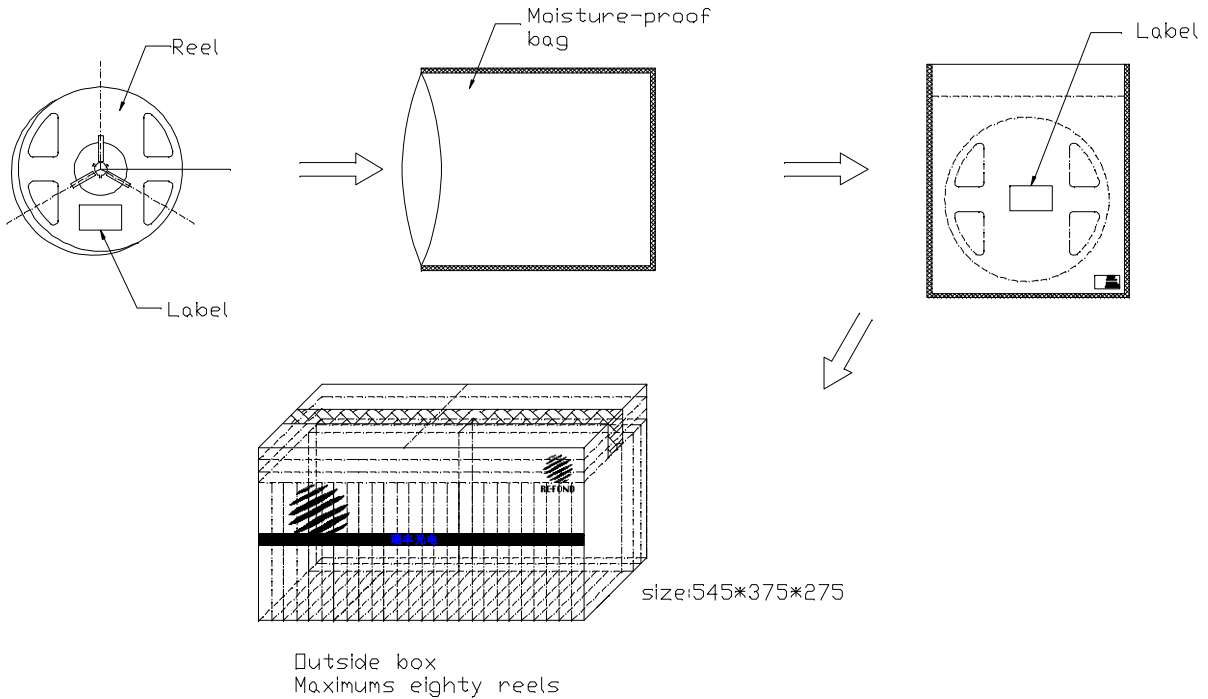

■ Label

PART NO:  
 SPEC NO:  
 LOT NO:

BIN CODE:  
 IV:  
 VF:  
 X/Y:

QTY:    PCS  
 DATE:

### CAUTIONS

#### Package specifications

Reeled products (numbers of products are 4,000pcs) packed in a seal off moisture-proof bag along with a desiccant one by one, Eighty moisture-proof bag of maximums are put the outside box (size: about 545mm x about 375mm x about 275mm) Together with buffer material, and it is packed. (Pare No., Lot No., quantity should appear on the label on the moisture-proof bag, part No. And quantity should appear on the label on the cardboard box.) The number of the loading steps of outside box (cardboard box) has two steps.

#### Storage conditions

##### Before opening the package:

The LEDs should be kept at 30°C or less and 70%RH or less. The LEDs should be used within a year. When storing the LEDs, moisture proof packaging with absorbent material (silica gel) is recommended.

##### After opening the package:

The LEDs should be kept at 30°C or less and 50%RH or less. If unused LEDs remain, they should be stored in moisture proof packages, such as sealed containers with packages of moisture absorbent material (silica gel). It is also recommended to return the LEDs to the original moisture proof bag and to reseal the moisture proof bag again.