

NEW PRODUCT

For LED Lamp

LEH CONNECTOR

1.8mm Pitch

Considering about the luminescence property of LED package and the mating operability, this LEH connector is designed as low profile type connector for LED lighting, and achieves the space saving. In consideration of connector mating operation to the LED mounting PCB that is integrated in the equipment, side-feed mechanism that provides to enable mating the connector from right above is adopted, and secure lock and mechanism for preventing wrong insertion are provided.



■ Features

● Low profile and space saving design

Mounting height at connector mounting side: 3 mm

● Secure lock mechanism

● Mechanism for preventing wrong insertion

● Halogen-free and RoHS compliant

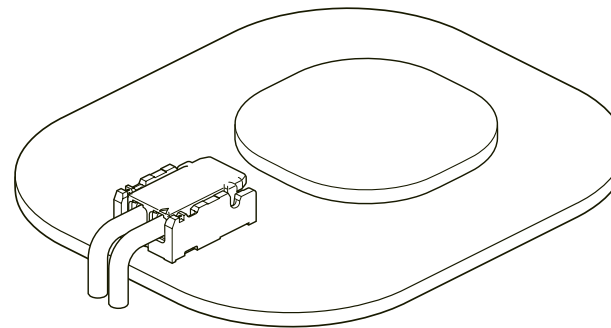

■ Specifications

- Current rating : 3A AC, DC (When using AWG#22)
- Voltage rating : 300V AC, DC
- Temperature range : -55°C to +105°C (including temperature rise in applying electrical current)
- Contact resistance : Initial value /10mΩ max.
After environmental testing /20mΩ max.
- Applicable wire : Conductor size /AWG #26 to AWG #22
Insulation O.D./0.95 to 1.3mm dia
- No. of Circuits : 2-circuit
- Part number : Header/BM02B-LEH()S-()-TB(HF)
: Socket Housing/LEHR-02V-()-() (HF)
: Contact/SLEH-001T-P0.15

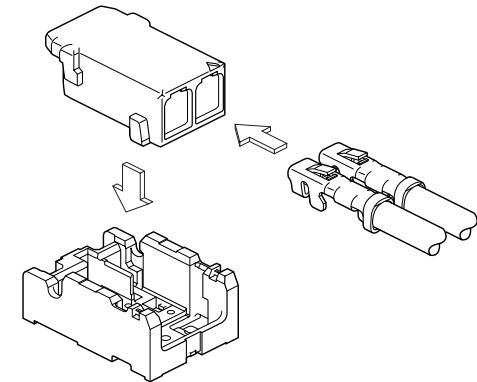

● Inserting method

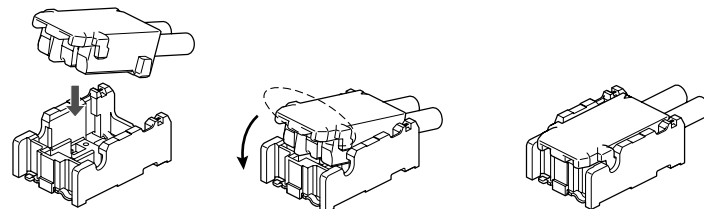

1. Insert the socket straightly while tilting it.

2. After inserting the socket, push the dotted oval part.

3. Completion of mating operation

● Withdrawing method

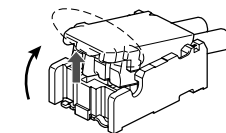

After picking up the dotted oval part, withdraw the socket straightly

J.S.T. MFG. CO., LTD.

<http://www.jst-mfg.com>